

iPad Setup Instructions, User Guide

Joshua Baird - 2024-06-14 - Public

This article will walk you through the steps to set up your iPad.

Step 1. Power on the iPad. You will be greeted with a “Hello” prompt. Tap anywhere on the screen or press the “Home” button to navigate to the Language screen. Tap “English” to continue.



Step 2. Select “United States” from the “Select Your Country or Region” screen.

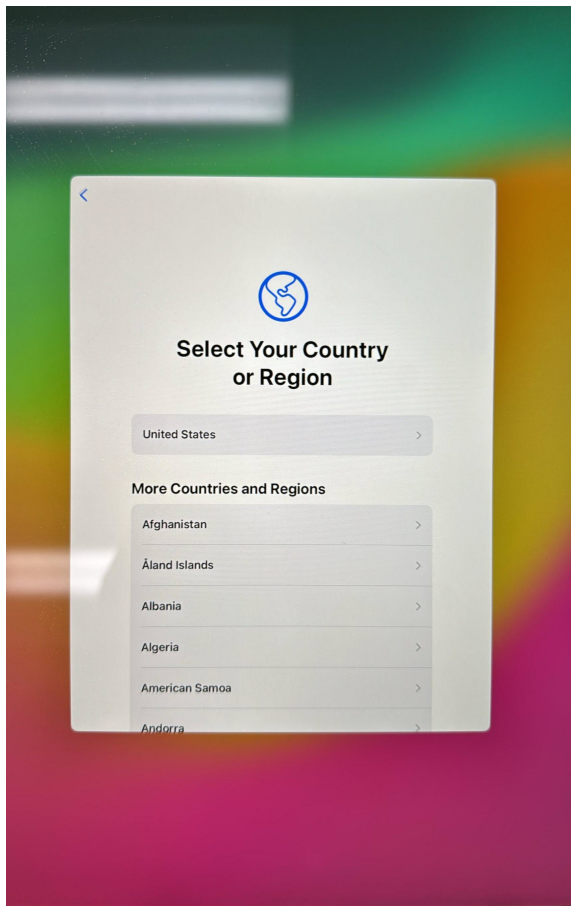

Step 3. From the “Appearance” screen, select the desired text and icon size and tap “Continue”.



Step 4. At the “Quick Start” screen, select the option to “Set Up Without Another Device”.

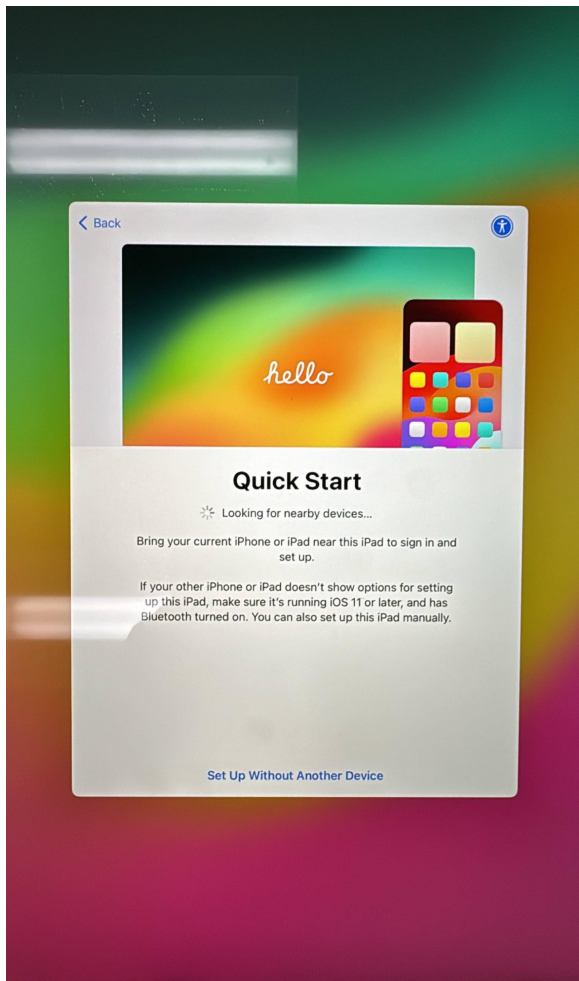

Step 5. Connect to your campus Wi-Fi.

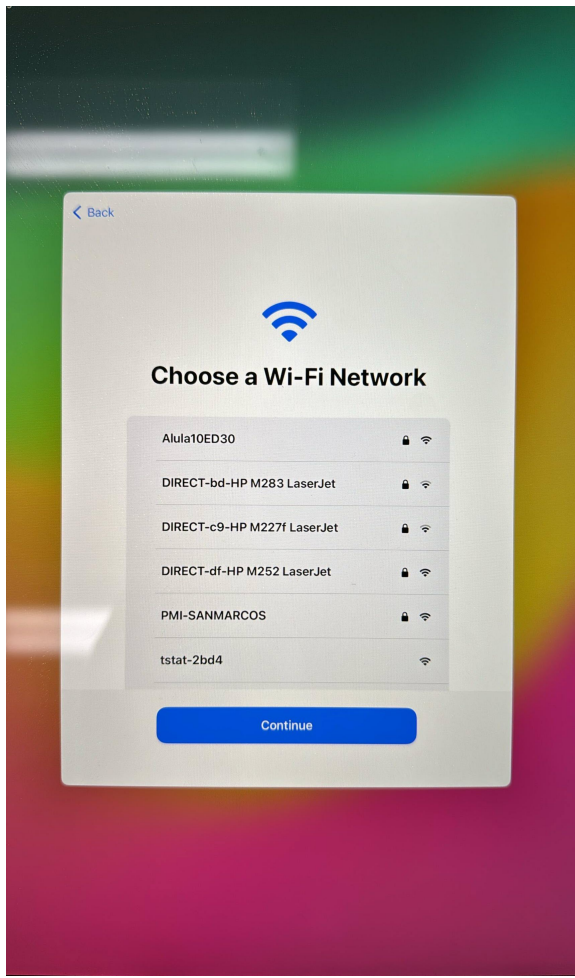

You may be greeted with the dialog "It may take a few minutes to activate your iPad". Please wait a few seconds.

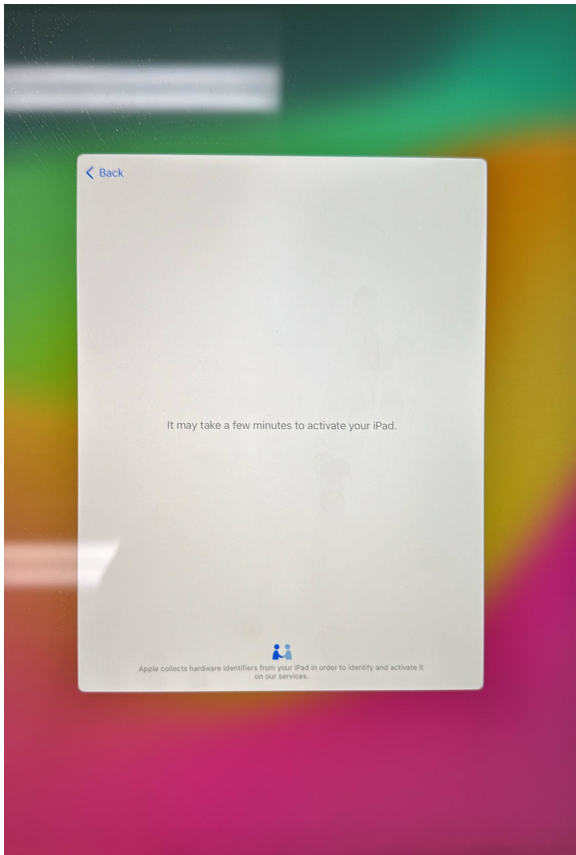

Step 6. Select "Continue" from the "Data & Privacy" screen.

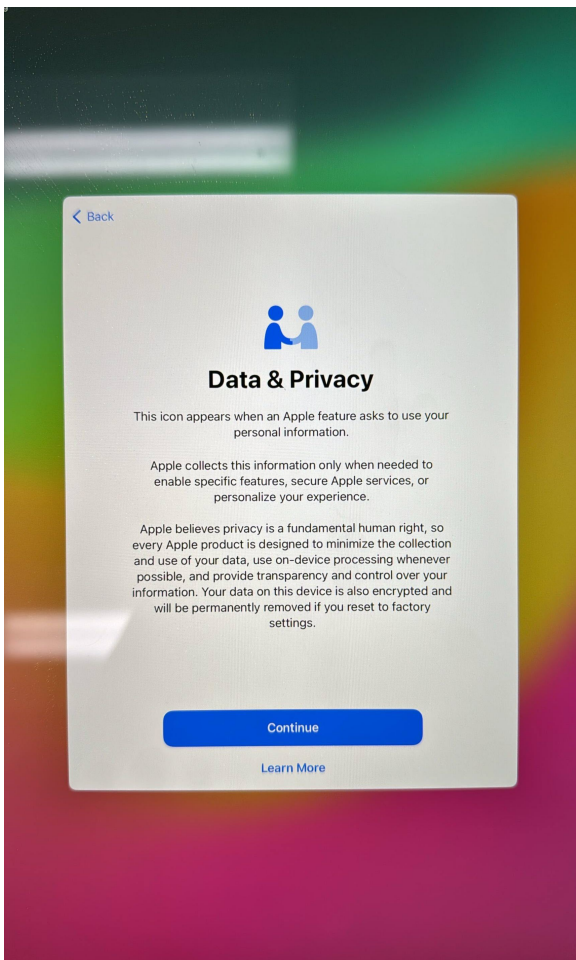

Step 7. Select “Enroll this iPad” from the “Remote Management” screen.

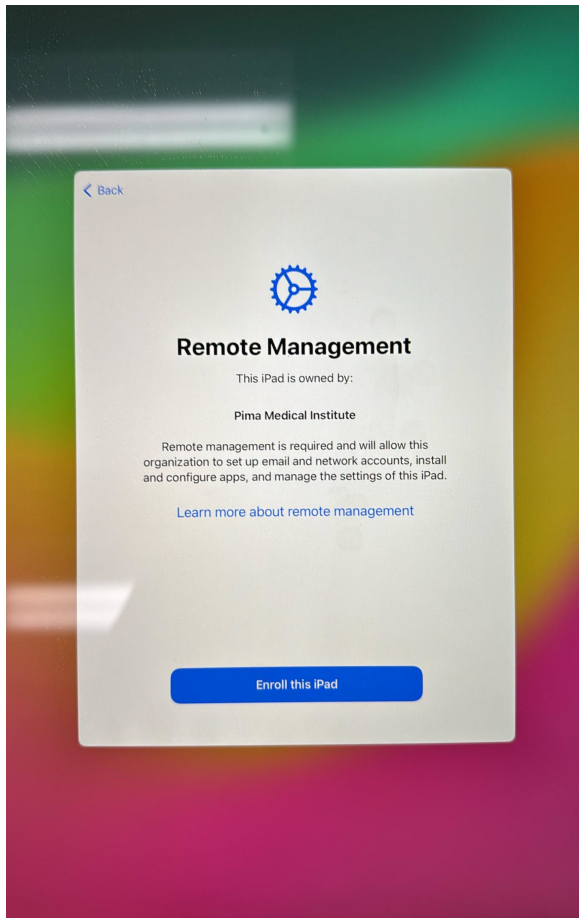

Step 8. From the Remote Management screen, enter your PMI credentials. Please do not include “@pmi.edu” when entering your username. Tap “Next” (top right) to continue.

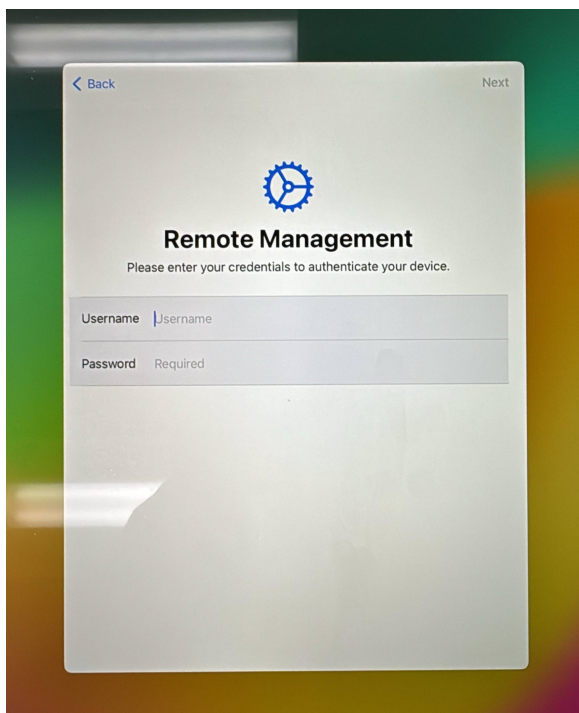

You may see a screen that says, "Awaiting final configuration". Please wait a few seconds.

Step 9. From the "Create a Passcode" screen, select the "Passcode Options". A dialog box will appear. Select "Don't Use Passcode".

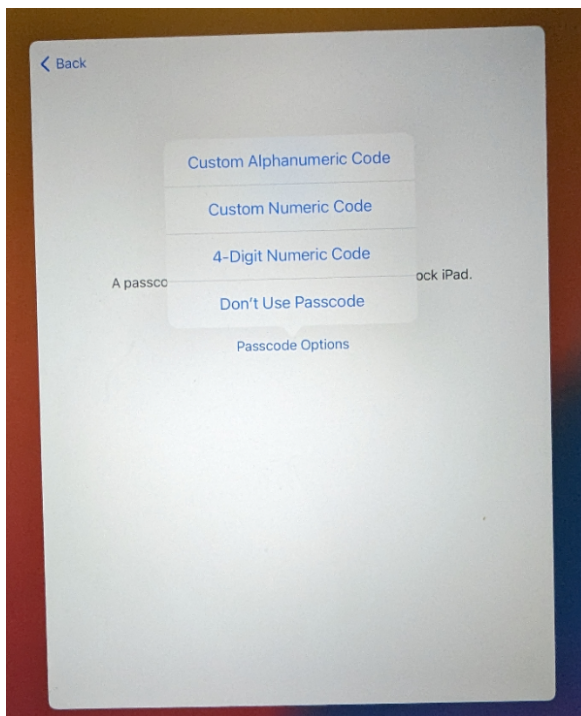
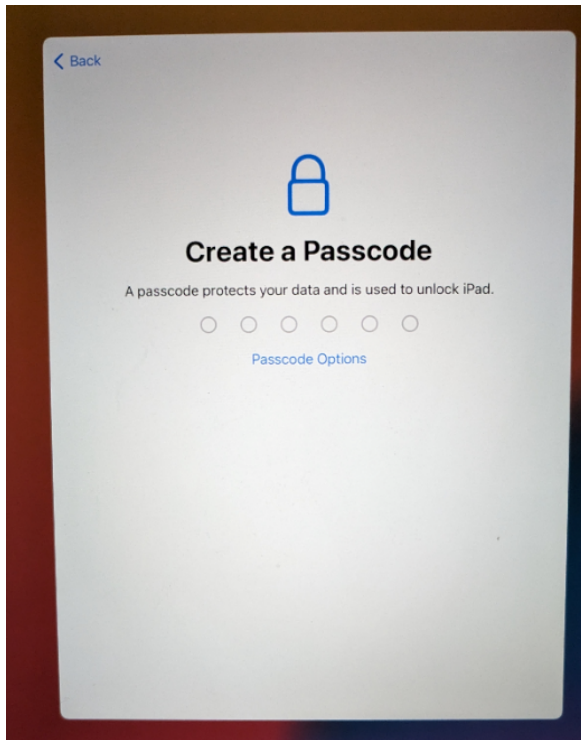

Step 10. From the "Using a Passcode is Highly Recommended" dialog box, tap "Don't Use Passcode".

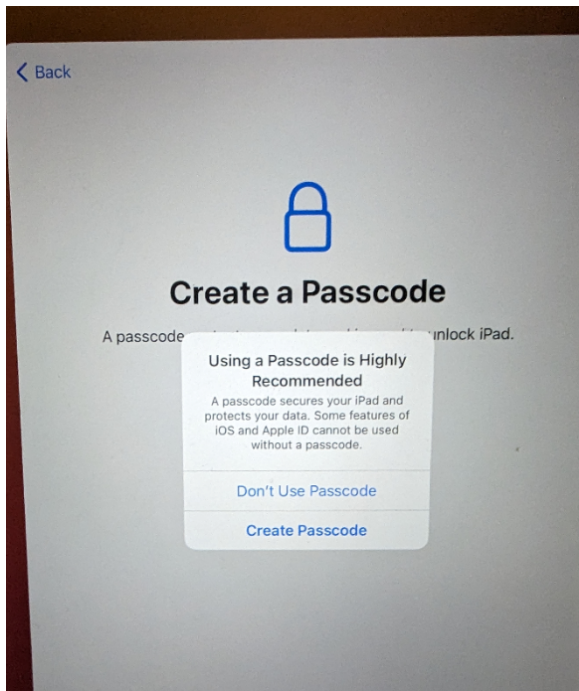

Step 11. At the “Keep Your iPad Up to Date” screen, select “Continue”.

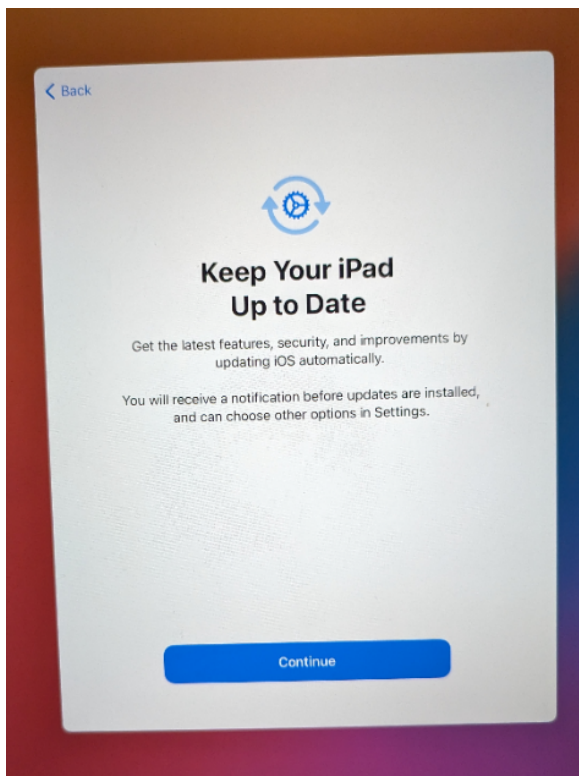

Step 12. Select “Set Up Later in Settings” from the “Screen Time” screen.

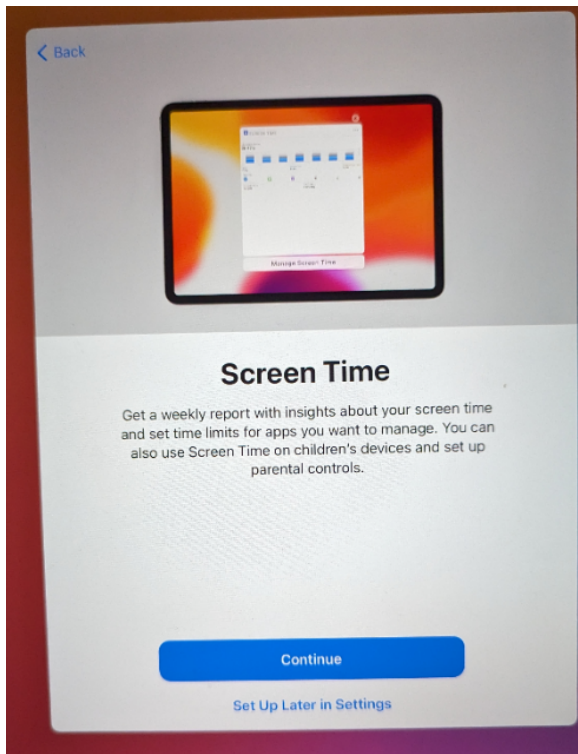

Step 13. From the “Location Services” screen, select “Enable Location Services”.

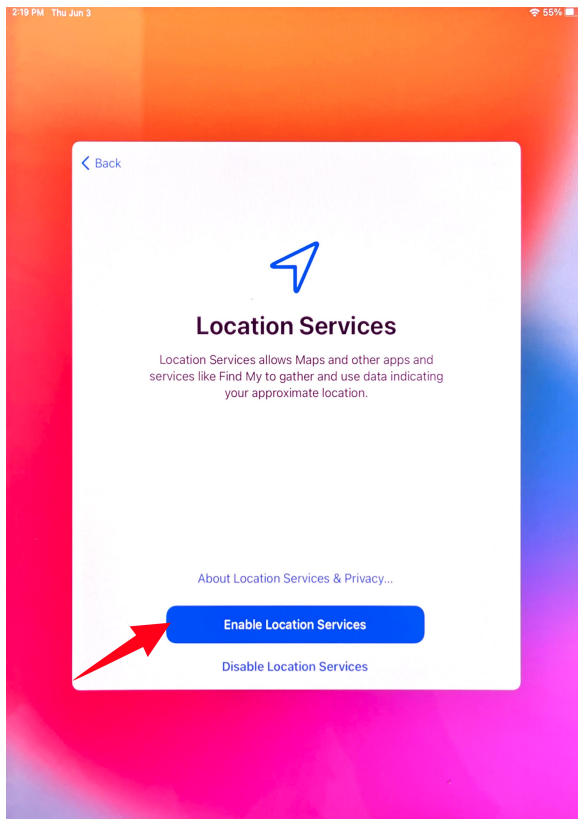

Step 14. At the “Appearance” screen, select a light or dark appearance and tap “Continue”.

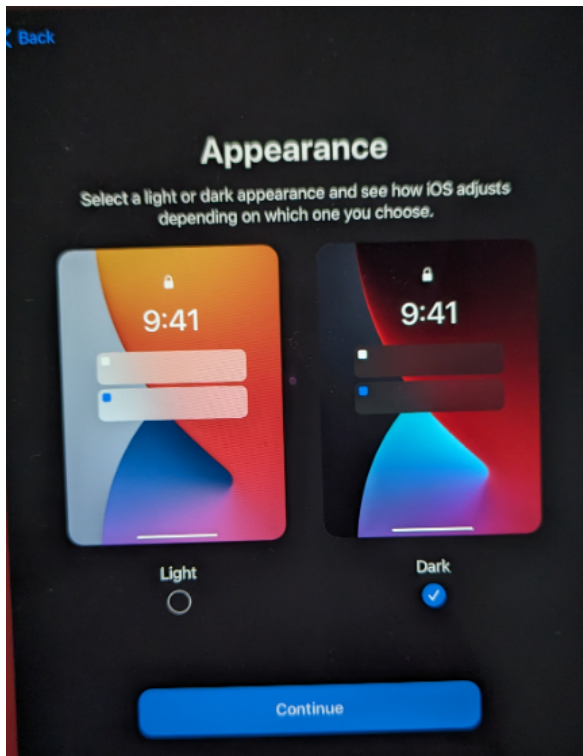

Step 15. At the “Welcome to iPad” screen, select “Get Started”.

